

FOR SALE



# HAREWOOD STREET OFF GREEN LANE ROAD LEICESTER LE5 3LW

## £254,800

### FEATURES

- Freehold
- Walking distance to schools, shops and places of worship
- Through lounge
- Downstairs shower room
- uPVC double glazing
- Sought after location
- Three bedrooms
- Kitchen
- Upstairs WC
- Gas central heating



 **SETHS**

# 3 Bedroom Terraced House for sale in Leicester

## GROUND FLOOR

### THROUGH LOUNGE

26'6" x 10'9"

Carpeted, x2 radiators, x2 uPVC double glazed windows

### KITCHEN

14'0" x 5'5"

Wall and base units with worktops over, 4 ring gas hob with built-in oven and extractor hood, sink with mixer tap and drainer, plumbing for washing machine, laminate flooring, partly tiled walls, uPVC double glazed window

### LOBBY

With access to the rear yard, laminate flooring, radiator, storage

### SHOWER ROOM

WC, ceramic round countertop basin with vanity units, walk-in shower cubicle, tiled flooring, tiled walls, extractor fan, towel radiator, uPVC double glazed window

## FIRST FLOOR

### BEDROOM 1

11'0" x 10'9"

Carpeted, radiator, fitted wardrobes, uPVC double glazed window

### BEDROOM 2

11'9" x 6'10"

Carpeted, radiator, fitted wardrobes, uPVC double glazed window

### BEDROOM 3

9'3" x 5'6"

Carpeted, radiator, fitted wardrobes, uPVC double glazed window

## WC

WC, wash hand basin with mixer tap, tiled flooring, partly tiled walls, towel radiator, uPVC double glazed window

## OUTSIDE

Small slabbed yard to the rear with low level brick walls surround. There is the added benefit of a wooden built storage shed.

## ADDITIONAL INFO

Tenure: Freehold

EPC rating: tbc

Council Tax Band: A (Leicester City Council)

Council Tax Rate: £1,605.15

Mains Gas: Yes

Mains Electricity: Yes

Mains Water: Yes

Mains Drainage: Yes

Broadband availability: Full Fibre Broadband



UPPINGHAM ROAD OFFICE SALES | 265 UPPINGHAM ROAD, LEICESTER, LE5 4DG

GROUND FLOOR

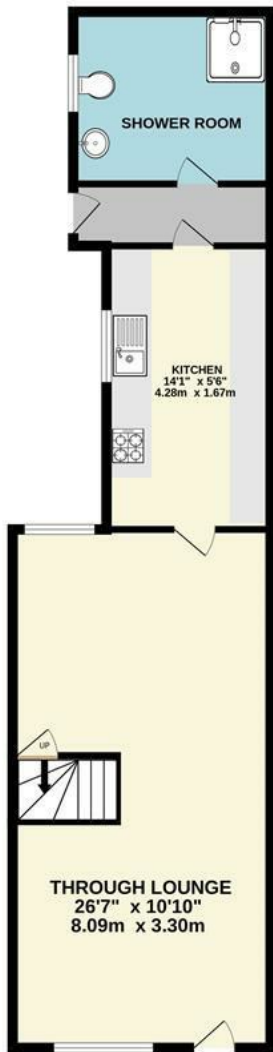

1ST FLOOR



Whilst every attempt has been made to ensure the accuracy of the floorplan contained here, measurements of doors, windows, rooms and any other items are approximate and no responsibility is taken for any error, omission or mis-statement. This plan is for illustrative purposes only and should be used as such by any prospective purchaser. The services, systems and appliances shown have not been tested and no guarantee as to their operability or efficiency can be given.  
Made with Metropix ©2025

Call us on  
**0116 266 9977**

[info@seths.co.uk](mailto:info@seths.co.uk)  
[www.seths.co.uk](http://www.seths.co.uk)

Council Tax Band  
**A**

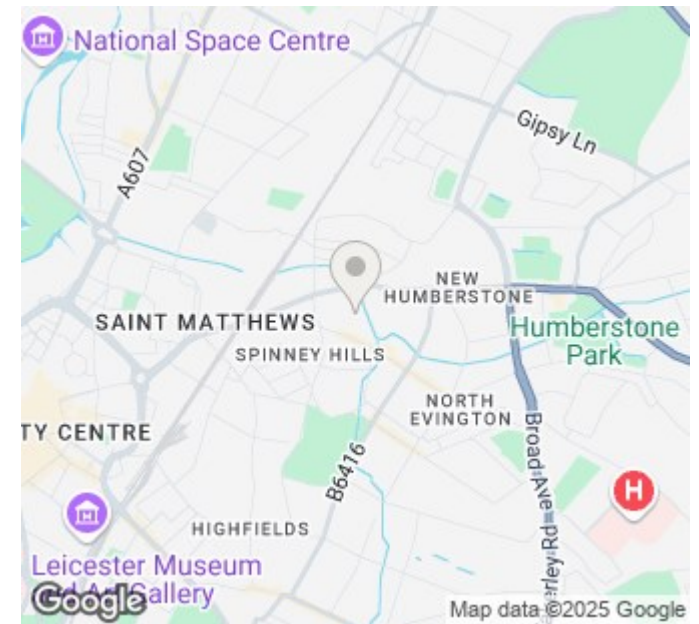

Agents Note: Whilst every care has been taken to prepare these particulars, they are for guidance purposes only. All measurements are approximate and are for general guidance purposes only and whilst every care has been taken to ensure their accuracy, they should not be relied upon and potential buyers are advised to recheck the measurements.

